



Cedar Lodge, Forton Bank, Montford Bridge, Shrewsbury, SY4 1ER
£1,000 Per Month



Cedar Lodge, Forton Bank, Montford Bridge, Shrewsbury, SY4 1ER

£1,000 Per Month

VIRTUAL TOUR AVAILABLE: Attractive three bedroom detached bungalow in a beautiful setting located a short distance from Shrewsbury in the desirable village of Montford Bridge.

Available: Immediately

Description

Comprising: Entrance hall, living room with open fire, new kitchen including oven, electric hob, space for dishwasher, space for fridge/freezer, boiler cupboard, pantry, dining area and door to rear utility and WC. Master bedroom, two further bedrooms, new bathroom including shower. Garden, driveway parking for three cars. Partial double glazing. Oil fired central heating. EPC E*

*The remaining single glazed windows are being upgraded to double glazing in November 2024.



Unfurnished

Council Tax Band: D

Available: 11th October 2024

EPC: E

Floor Plans

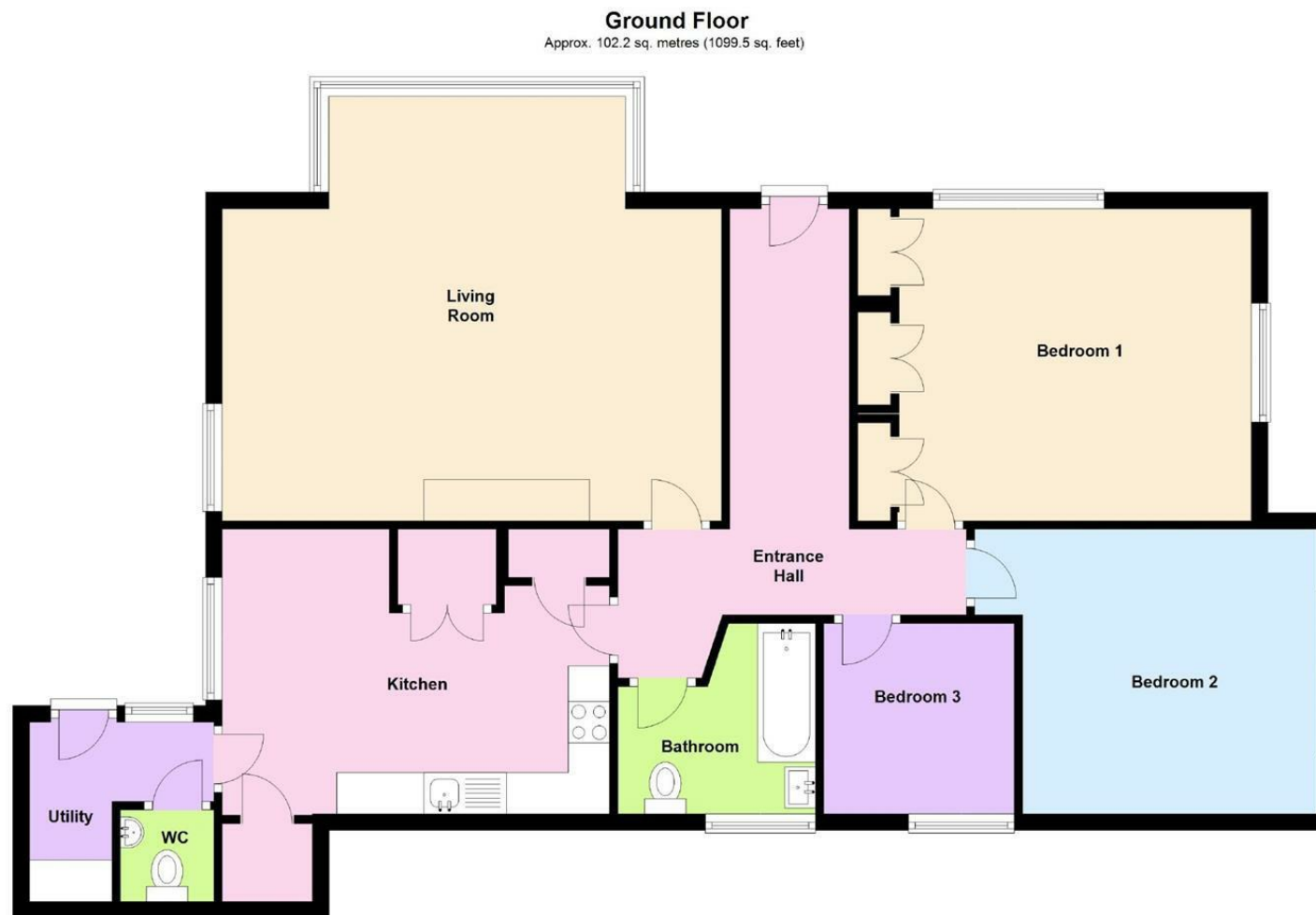

We accept no responsibility for any mistake or inaccuracy contained within the floorplan. The floorplan is provided as a guide only and should be taken as an illustration only. The measurements, contents and positioning are approximations only and provided as a guidance tool and not an exact replication of the property.

Plan produced using PlanUp.

These particulars, whilst believed to be accurate are set out as a general outline only for guidance and do not constitute any part of an offer or contract. Intending purchasers should not rely on them as statements of representation of fact, but must satisfy themselves by inspection or otherwise as to their accuracy. No person in this firm's employment has the authority to make or give any representation or warranty in respect of the property.